

A SPECIAL VENUE FOR SPECIAL EVENTS



Technical Rider



Théâtre Desjardins is managed by the Société de la salle Jean-Grimaldi. It's main partners are the Borough of LaSalle and André-Laurendeau Cegep. Equipped with state-of-the-art lighting, projection and sound equipment, Théâtre Desjardins attracts some 60,000 spectators every season for events ranging from professional stage performances to promotional events.

Whether you are organizing a corporate event, a general assembly, a talent show, a gala or a conference we provide:

- ◆ **A large-scale hall designed to accommodate spectators and clients with comfort and ease**
- ◆ **813 comfortable seats offering optimal stage views at every vantage point and 314 seats with a half-hall configuration**
- ◆ **State-of-the art projection and sound equipment**
- ◆ **Professional technical support**
- ◆ **Courteous service**
- ◆ **Bar, box office, ushers and coat check**
- ◆ **Located near main highways and bridges (Champlain and Mercier), our venue offers a large parking lot with 1000 parking spaces.**
- ◆ **Easy access to Angrignon metro**
- ◆ **Being part of André-Laurendeau Cégep, we can offer rental spaces such as, classrooms, cafeteria, gymnasium or other premises to cater to your specific needs.**

Rental Informations :

Line Hamel, Coordinatrice aux événements et locations

Phone : 514-367-6373 #6882, email : lhamel@theatredesjardins.com

Technical Informations :

Stéphane Boivin, dt@theatredesjardins.com phone: 514-367-6373 # 6165

1111, rue Lapierre, Arrondissement LaSalle, Montréal, Québec, H8N 2J4

www.theatredesjardins.com

Technical rider

CAPACITY	813 seats (Full venue) 314 seats (Half venue)																		
STAGE	<table style="width: 100%; border-collapse: collapse;"> <tr> <td style="width: 60%;">With of stage frame</td> <td style="width: 20%; text-align: right;">47'8"</td> <td style="width: 20%; text-align: right;">14.5 m</td> </tr> <tr> <td>Hight of stage frame</td> <td style="text-align: right;">17'5"</td> <td style="text-align: right;">5.3 m</td> </tr> <tr> <td>Depth of stage</td> <td style="text-align: right;">37'0"</td> <td style="text-align: right;">11.2 m</td> </tr> <tr> <td>Forestage</td> <td style="text-align: right;">6'0"</td> <td style="text-align: right;">1.8 m</td> </tr> <tr> <td>With of stage (wall to wall)</td> <td style="text-align: right;">55'5"</td> <td style="text-align: right;">16.9 m</td> </tr> <tr> <td>Lighting grid Hight</td> <td style="text-align: right;">18',3"</td> <td style="text-align: right;">5.6 m</td> </tr> </table>	With of stage frame	47'8"	14.5 m	Hight of stage frame	17'5"	5.3 m	Depth of stage	37'0"	11.2 m	Forestage	6'0"	1.8 m	With of stage (wall to wall)	55'5"	16.9 m	Lighting grid Hight	18',3"	5.6 m
With of stage frame	47'8"	14.5 m																	
Hight of stage frame	17'5"	5.3 m																	
Depth of stage	37'0"	11.2 m																	
Forestage	6'0"	1.8 m																	
With of stage (wall to wall)	55'5"	16.9 m																	
Lighting grid Hight	18',3"	5.6 m																	
STAGE WING	<table style="width: 100%; border-collapse: collapse;"> <tr> <td style="width: 60%;">Stage Right Clearance</td> <td style="width: 20%; text-align: right;">6'6"</td> <td style="width: 20%; text-align: right;">2.0 m</td> </tr> <tr> <td>Stage Left Clearance</td> <td style="text-align: right;">3'3"</td> <td style="text-align: right;">1.0 m</td> </tr> </table>	Stage Right Clearance	6'6"	2.0 m	Stage Left Clearance	3'3"	1.0 m												
Stage Right Clearance	6'6"	2.0 m																	
Stage Left Clearance	3'3"	1.0 m																	
STAGE FLOOR	Wood surface covered with black linoleum. It is forbidden to screw or nail into the stage floor.																		
ELECTRICAL PANELS (Less than 50' from the stage)	1- 120/208 V., 3 phases, 400 Amps. Pannel (Lighting) 1- 120/208 V., 3 phases, 200 Amps. Pannel (Sound)																		
CONTROL TABLE	Centered at mid room, 12' (3.6 m) wide and 49'6" from the stage.																		
ACCES	Freight elevator: With 8' (2.4 m), Depth 10' (3.0 m) Hight 8' (2.4 m) Located at the front at door no.5 of the Cégep and overlooking the back of the stage. Please note that equipment is unloaded using a ramp and that any part that cannot be contained in the freight elevator must pass through the stairs.																		
Main stage curtain	Black velour drape (Manually operated).																		

STAGE DRESSING	2 Black side drapes	25' (7.6 m) Wide X 18'3" (5.56 m) High
	5 pairs Black wings	54" (1.4 m) Wide X 18'3" (5.56 m) High
	4 Black valence	48' (14.6 m) Wide X 18" (0.4 m) High
	1 pvc cyclorama	48' (14.6 m) Wide X 20' (6.1 m) High

LOGES	Located less than 15 '(4.5 m) from the stage, courtyard side, behind the stage. 1 lodge that can accommodate 2 people and 1 lodge that can accommodate 8 people.
	Accessible from both sides of the stage
	Each lodge is equipped with toilet, sink, shower and makeup mirrors

LIGHTING

CONSOLES	Grand MA Dot2 with Fader Wing ETC Express 48/96
-----------------	--

DIMMERS	84 Strand CD80 de 2.4 K
----------------	-------------------------

SPOTLIGHTS	Leko ETC Source Four 19 degrés 750W	2
	Leko ETC Source Four 26 degrés 750W	12
	Leko ETC Source Four 36 degrés 750W	12
	Leko ETC Source Four Zoom 25-50 750W	4
	Leko ETC Source Four Zoom 25-50 750W (FOH)	20
	Par ETC Sour Four PAR EA 750W	24
	Par64 1000W	24
	Fresnel ETC Source Four PARNel 750W	12
	Fresnel Strand Fresnelite 6", 750W	12
	Iris Skycyc3 Altman	6
	Orion Groundcyc Strand	6
	Colorblast TRX Color Kinetics	24

FOLLOW SPOT	Robert Juliat Victor 1800W	1
--------------------	----------------------------	---

SMOKE GENERATOR	MDG Atmosphère	1
------------------------	----------------	---

AUDIO EQUIPMENT

CONSOLE	1 Console numérique avec 3 boitiers 16x8 Yamaha M7CL-ES 48x24 1 Midas M32	
----------------	--	--

AUDIO SYSTEM	8 INPUT CARD lignes DB25 Yamaha	1
	8 pré-amp 1RU Yamaha MLA8	1
	CD Player Tascam CD200i	1
	Recorder SSD/CD Tascam SS-CDR1	1
	Processor DSP audio Yamaha DME64N	1
	Ethersound Auvitran AVY16-ES100 Card	1
	Multi-effex SPX-900	1

MAIN Audio system	Nexo S1210 - Full range Speakers	6
	Nexo S1230 - Full range Speakers	2

Front fill Audio	Passive Yamaha IF2208 Full range speakers + community cpl27	4
-------------------------	---	---

Subwoofers	Passifs Nexo RS18CI - Subwoofers	2
-------------------	----------------------------------	---

AMPLIFICATION	Main PA Nexo NXAMP4X4	2
	Delays/Appoints Lab Gruppen C20:8X	1
	Monitors Crown XTi4000	4
	Pre-Amplified Monitors QSC modèle HPR 122	4

STAGE MONITORS	12" JBL SRX712M	6
	15" JBL VRX915M	2

MICROPHONES ET ACCESSORIES	Microphone Shure SM57	4
	Microphone Shure SM58	6
	Microphone Shure Beta52	1
	Microphone Shure Beta91	1
	Microphone Sennheiser e935	6
	Microphone Sennheiser e904	4
	Microphone Sennheiser e906	2
	Microphone Sennheiser e965	2
	Microphone Sennheiser e914	4
	Microphone Sennheiser MD-421	1
	Microphone AKG-460	2
	Microphone AKG-C-391	2
	Microphone "Matched Pair" Rode NT5-MP	4
	Microphone Crown PZM30D	2
	Microphone condensateur de podium	1
	Wireless Hand held Microphone kit Sennheiser EW-335-G3	2
	Wireless Head Set Microphone kit Sennheiser EW-352-G3	2
	Wireless microphone kit with Head Set and Hand Held. Shure UC (GTR124C/58 WH20TQS)	1
	Microphone Wireless Sennheiser EW-SKM-835-G3	2
	Direct Box passive radial engineering JDI	2
	Direct Box active engineering J48	6
	Direct Box stereo radial engineering JDI duplex	1
	Boom stand long telescopic K&M 210/9	16
Boom stand short K&M 25950	6	
Microphone stand round base K&M 26000-300-5	4	
Table Microphone stand	2	

CABLING	Sub snake 8/4 x 50'	1
	Sub snake 12/4 x 100'	1
	Cables XLR 10'	10
	Cables XLR 25'	25
	Cables XLR 50'	20

COMMUNICATION	ClearCom CC-95 1 cup head-set	5
	ClearCom CC-260 2 cups Head-set	6
	ClearCom A-B belt pack,	6
	ClearCom wireless base DX410	1
	ClearCom wireless Belt Pack with head-set BP410	4

VIDEO AND MULTIMEDIA

VIDEO	Motorised screen 133" x 236" HDTV Da-Lite Professional Electrol	
	Camera Panasonic WV-CP500+ support	1
	Bluray Player Denon DBP-2010CI	1
	Projector Sanyo PDG-DHT8000L 8000 lumens Full HD	1
	Video Amplifier 1:5 Kramer VM-1015	1
	Satellite receiver/Câble TBD	1

CRESTRON CONTROLER	Matrice multimedia 8x8 Crestron DM-MD8X8	1
	Carte entré HDMI Crestron DMC-HD-DSP	1
	Carte entrée Analogue BNC Crestron DMC-VID-BNC	2
	Carte entrée DM avec "Downmix" Crestron DMC-CAT-DSP	3
	Carte sortie DM Quad Crestron DMCO-55	1
	Carte sortie HDMI double Crestron DMCO-30	1
	Répeteur DM Crestron DM-DR	3
	Module d'entrée mural Crestron DM-TX-400-3G	3
	Module de sortie Crestron DM-RMC-100-C	3
	Panneau de contrôle Crestron TPMC-4SMD-B-S + acc	1
	Contrôleur central + alimentation Crestron CP2E	1
	Point d'accès sans fil Crestron CEN-WAP-ABG-1G	1
	Injecteur POE Crestron PWR-4803R	2
Contrôle d'écran Crestron C2N-SDC	1	

Misc and Accessories

Personal lift JLG MLV-20 (motorized)	1
Music Lecterns	14
Lights for Music Lecterns	14
Black Drapes 13'w X 12'h (Freestanding)	18
X-Floor bases	8
Round floor bases	8
Pipes - 2 x 14', 1 x 12', 1 x 10', 2 x 7', 4 x 6', 1 x 4'	

LIGHTING GRID - THÉÂTRE DESJARDINS

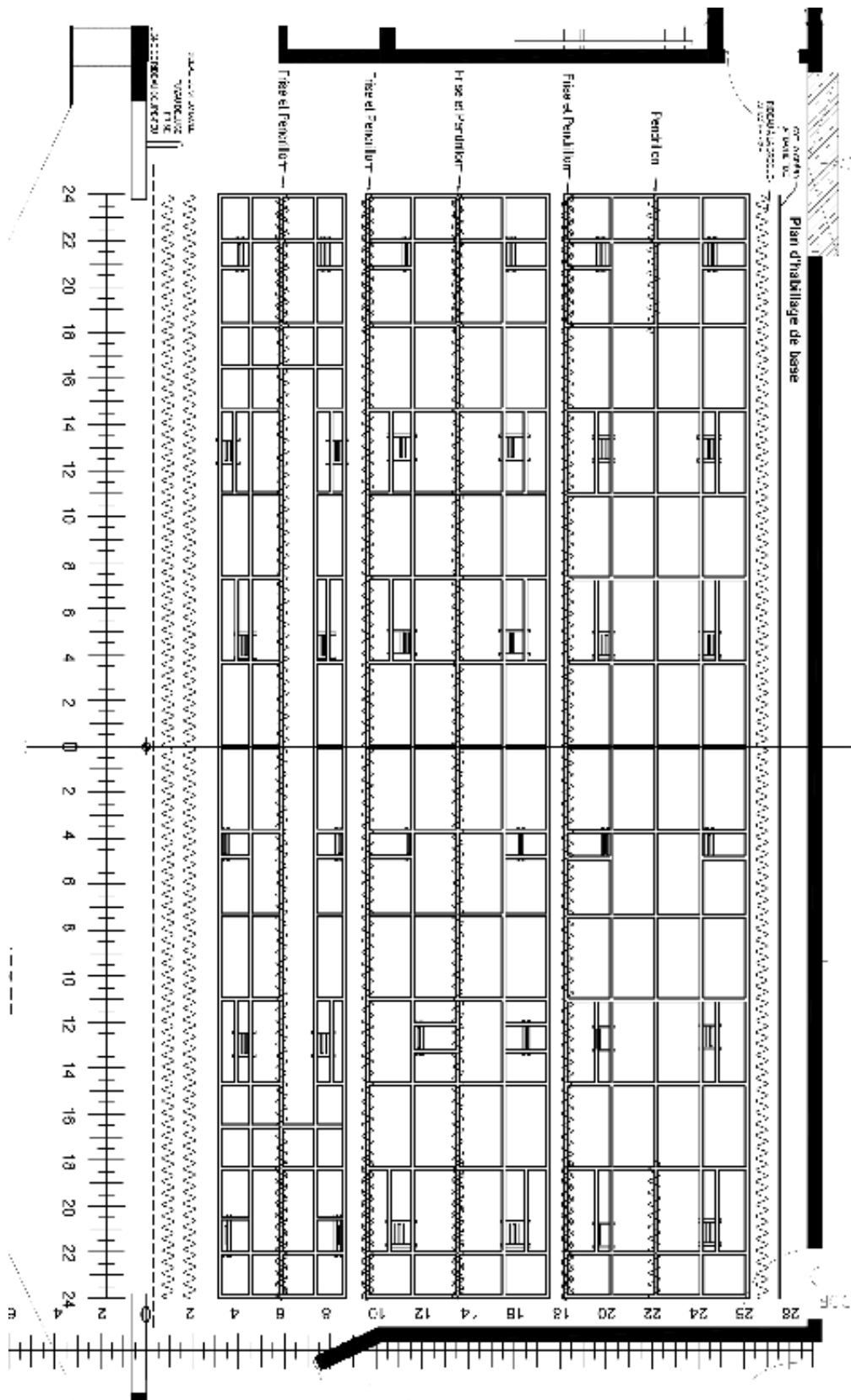

SEATING PLAN - THÉÂTRE DESJARDINS

